

Monarch™ Overhead Arm Positioner

CIVCO Technical Data Sheet



| | | |
|------------------------------------|---|--|
| Product Name | Monarch™ Overhead Arm Positioner | |
| Product Number | OAP110 | Monarch Overhead Arm Positioner for use with Lok-Bar™ |
| | OAP100 | Monarch Overhead Arm Positioner, upgrade kit for MT400 C-Qual™ Breastboard |
| | OAP120 | Monarch Thermoplastic Frame Only, Upgrade Kit for Monarch Overhead Arm Positioner |
| | OAP160 | Monarch Individual Hand Grips |
| General Description | The Monarch Overhead Arm Positioner is 23.4" (59 cm) wide and features dual function hand grips that allow for natural flexion of the patient's wrists while providing increased positioning options for the clinician. | |
| Indications for use | OAP110 OAP160 | The device is intended to support and aid in positioning a patient during radiologic and other medical procedures. Devices are used to aid in the support and positioning of patients during an MRI. |
| | OAP100 OAP120 | The device is intended to support and aid in positioning a patient during radiologic and other medical procedures. |
| MRI Compatible | OAP110 OAP160 | MR Conditional. Product poses no known hazard in 1.5 and 3.0T MR environments. |
| Integration | 3-Pin Indexable to Couchtop or available as an upgrade kit for use with MT400 C-Qual Breastboard. | |
| FDA Clearance | Yes | |
| CE Marked (EU DOC) | Yes | |
| Other Country Registrations | Available upon request | |
| Country of Manufacture | USA | |

Technical Details

| | | |
|--------------------------|--|--------------------------------|
| Primary Materials | Kydex T thermoplastic, Black Acetal, Black ABS | |
| Weight (approx) | 3.9 kg / 8.5 lbs. (OAP110) | 5 kg / 11 lbs. (OAP100) |
| Dimensions (mm) | 632 L x 594 W x 187 H (OAP110) | 632 L x 594 W x 246 H (OAP100) |

Technical Drawing (OAP110)

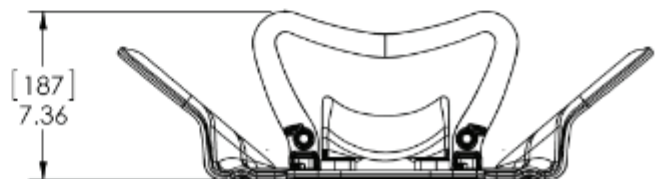
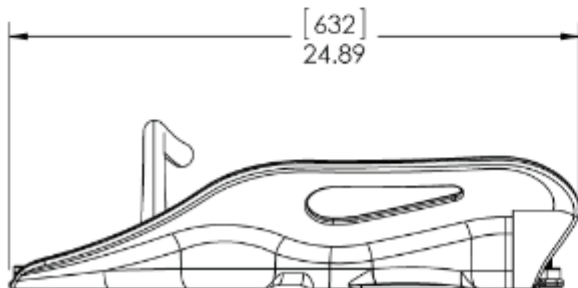
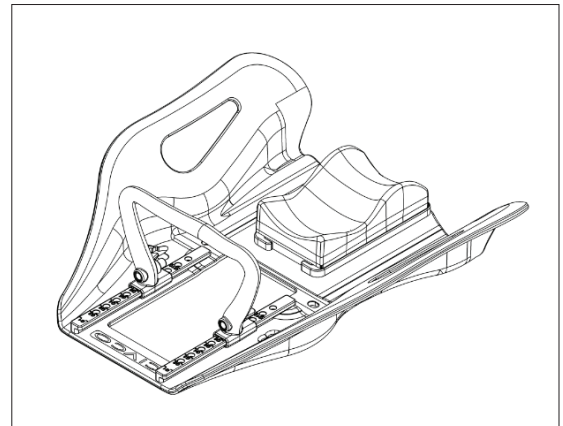
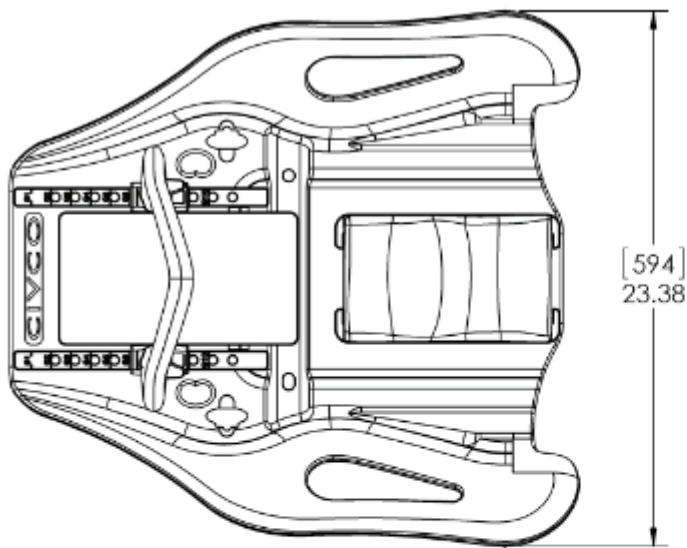

Technical Drawing (OAP100)

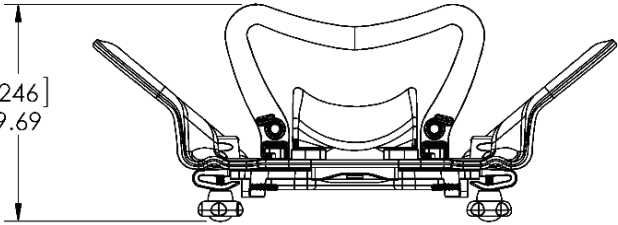
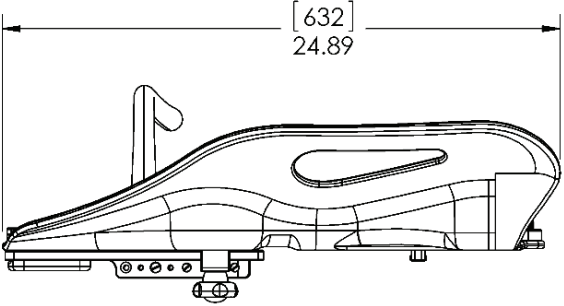
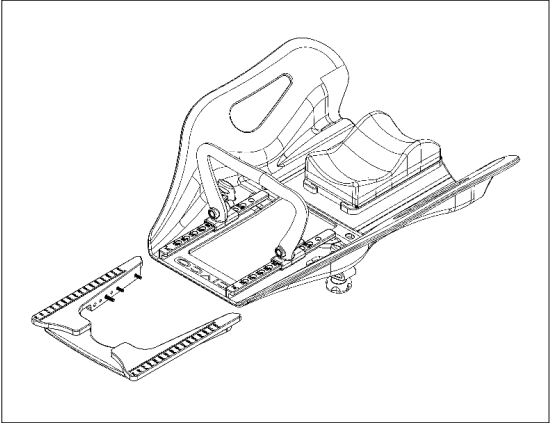
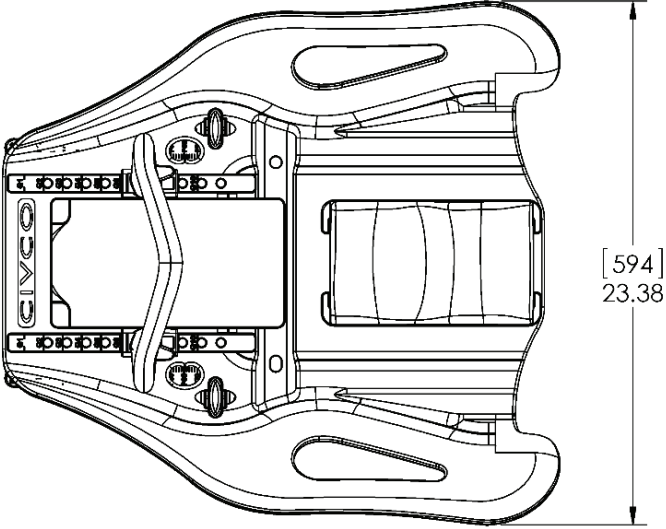

Technical Details

Primary Materials Black Acetal, White Delrin

Weight (approx) .27 kg / .60 lbs.

Dimensions (mm) 274 L x 100 W x 16 H

Technical Drawing (OAP120)

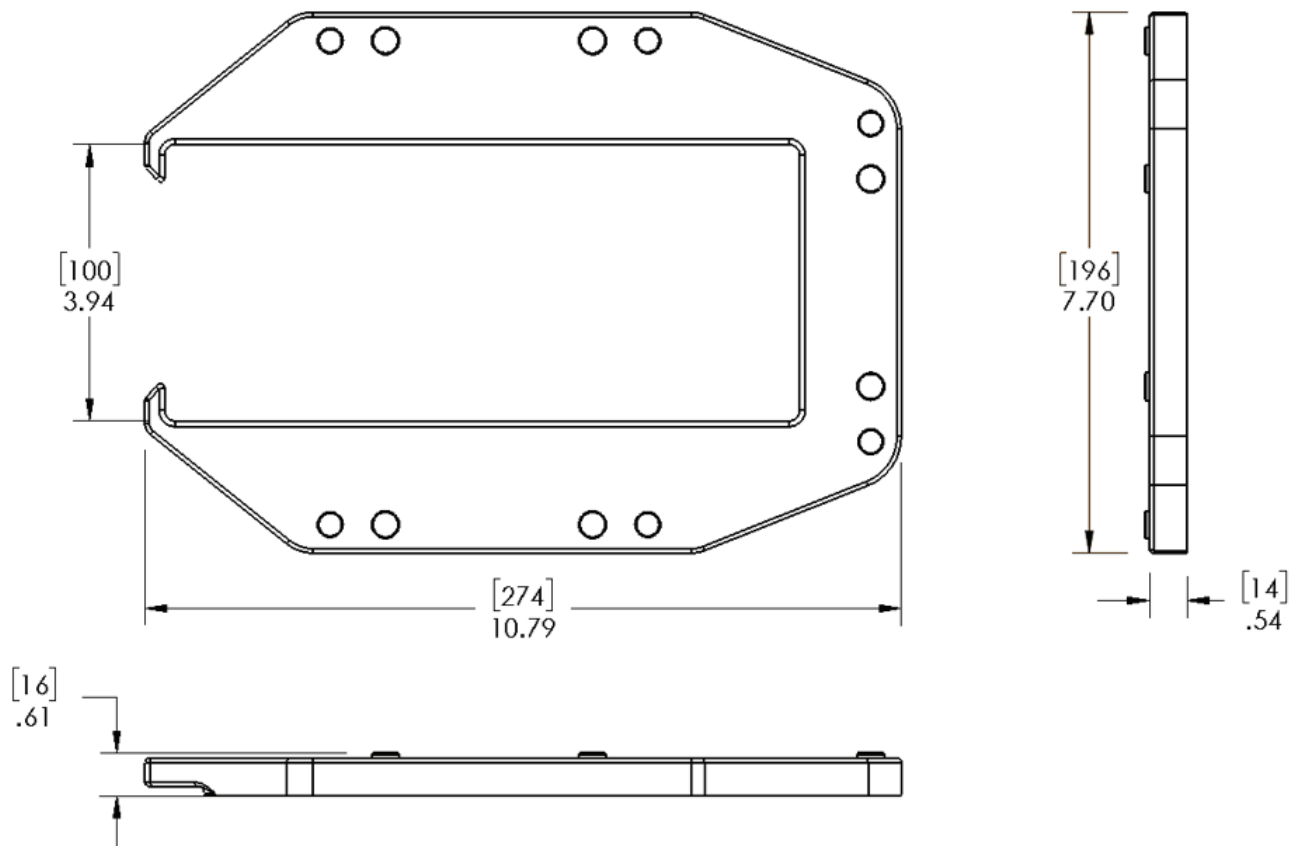

Technical Details

Primary Materials Black ABS, White Acetal

Weight (approx) .25 kg / .55 lbs

Dimensions (mm) 80 L x 52 W x 201 H

Technical Drawing (OAP160)

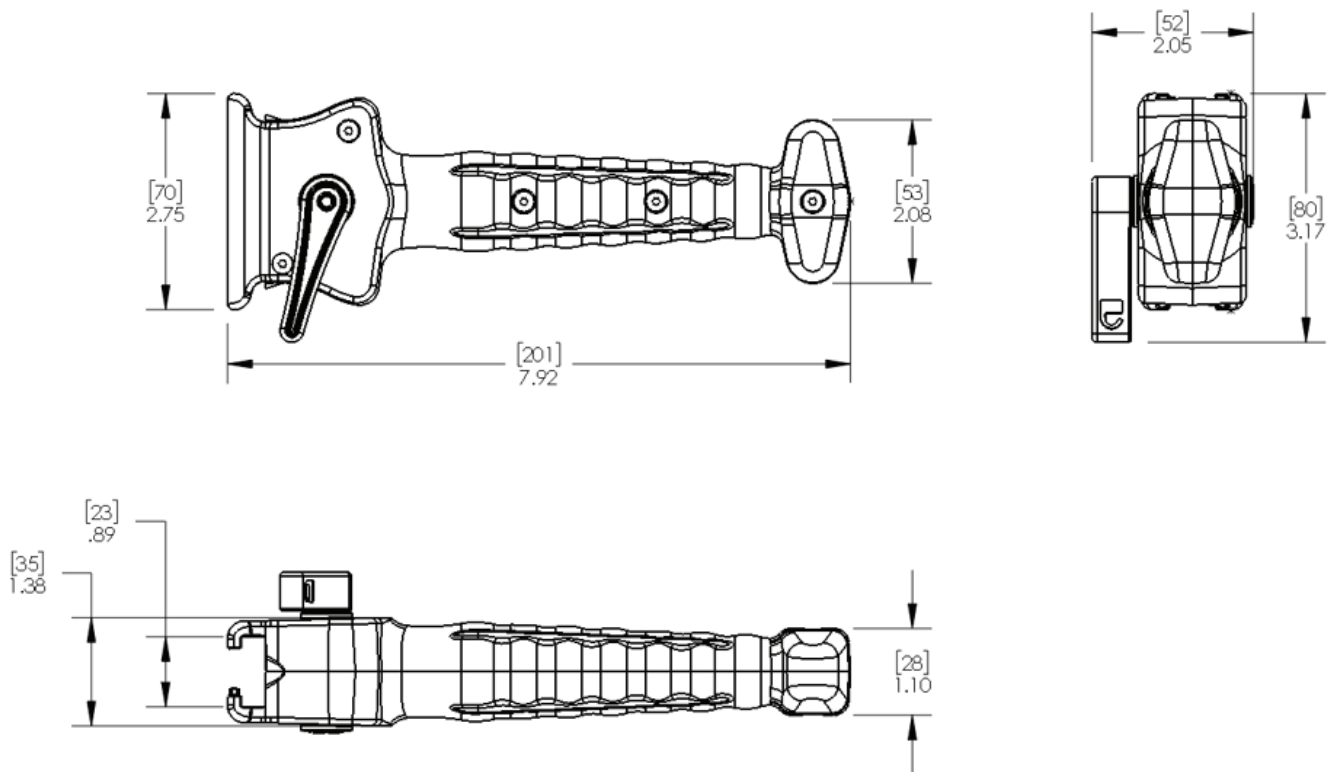

Packaging

| | |
|----------------------|--|
| Unit Pack | Each |
| Units / Box | One device - may have several component parts in box |
| Shelf Life | n/a |
| Warranty | See CIVCO website for Product Warranty Statement |
| Sterilization | Non-Sterile |
| Launch Date | October 2015 |

Accessories

| | |
|-----------------------------|---|
| System Customization | Compatible with: Mastercast™ Pro Head-Only Thermoplastics (with OAP120) Posicast® Head-Only Thermoplastics (with OAP120) Posifix® Headrests Vac-Lok™ Cushions |
|-----------------------------|---|

Global Sales Office

Orange City, Iowa, USA
800.842.8688 | +1 712.737.8688

info@CivcoRT.com
www.CivcoRT.com

